

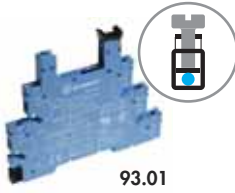

Automatización Eléctrica
Especialistas en Automatización

At the end of this document you will find links to products related to this catalog. You can go directly to our shop by clicking [HERE](#). [HERE](#)

Electromechanical Relay & Socket Combinations



Screw terminal - 1 Pole relay 6 A

Interface Module Code	Coil voltage	Relay	Socket
38.51.0.012.0060	12 V AC/DC	34.51.7.012.0010	93.01.0.024
38.51.0.024.0060	24 V AC/DC	34.51.7.024.0010	93.01.0.024
38.51.0.048.0060	48 V AC/DC	34.51.7.048.0010	93.01.0.060
38.51.0.060.0060	60 V AC/DC	34.51.7.060.0010	93.01.0.060
38.51.0.125.0060	(110...125)V AC/DC	34.51.7.060.0010	93.01.0.125
38.51.0.240.0060	(220...240)V AC/DC	34.51.7.060.0010	93.01.0.240
38.51.3.125.0060	(110...125)V AC/DC	34.51.7.060.0010	93.01.3.125
38.51.3.240.0060	(230...240)V AC	34.51.7.060.0010	93.01.3.240
38.51.7.006.0050	6 V DC	34.51.7.005.0010	93.01.7.024
38.51.7.012.0050	12 V DC	34.51.7.012.0010	93.01.7.024
38.51.7.024.0050	24 V DC	34.51.7.024.0010	93.01.7.024
38.51.7.048.0050	48 V DC	34.51.7.048.0010	93.01.7.060
38.51.7.060.0050	60 V DC	34.51.7.060.0010	93.01.7.060
38.51.8.240.0060	(230...240)V AC	34.51.7.060.0010	93.01.8.240



Screwless terminal - 1 Pole relay 6 A

Interface Module Code	Coil voltage	Relay	Socket
38.61.0.012.0060	12 V AC/DC	34.51.7.012.0010	93.51.0.024
38.61.0.024.0060	24 V AC/DC	34.51.7.024.0010	93.51.0.024
38.61.0.125.0060	(110...125)V AC/DC	34.51.7.060.0010	93.51.0.125
38.61.0.240.0060	(220...240)V AC/DC	34.51.7.060.0010	93.51.0.240
38.61.3.125.0060	(110...125)V AC/DC	34.51.7.060.0010	93.51.3.125
38.61.3.240.0060	(230...240)V AC	34.51.7.060.0010	93.51.3.240
38.61.7.012.0050	12 V DC	34.51.7.012.0010	93.51.7.024
38.61.7.024.0050	24 V DC	34.51.7.024.0010	93.51.7.024
38.61.8.240.0060	(230...240)V AC	34.51.7.060.0010	93.51.8.240



Screw terminal - 1 Pole relay 16 A

Interface Module Code	Coil voltage	Relay	Socket
38.01.7.012.0050	12 V DC	41.61.9.012.0010	93.02.7.024
38.01.7.024.0050	24 V DC	41.61.9.024.0010	93.02.7.024
38.01.7.060.0050	60 V DC	41.61.9.060.0010	93.02.7.060
38.01.0.024.0060	24 V AC/DC	41.61.9.024.0010	93.02.0.024
38.01.0.060.0060	60 V AC/DC	41.61.9.060.0010	93.02.0.060
38.01.0.125.0060	125 V AC/DC	41.61.9.110.0010	93.02.0.125
38.01.0.240.0060	240 V AC/DC	41.61.9.110.0010	93.02.0.240
38.01.8.230.0060	230 V AC	41.61.9.110.0010	93.02.8.230



Screwless terminal - 1 Pole relay 16 A

Interface Module Code	Coil voltage	Relay	Socket
38.11.7.012.0050	12 V DC	41.61.9.012.0010	93.52.7.024
38.11.7.024.0050	24 V DC	41.61.9.024.0010	93.52.7.024
38.11.7.060.0050	60 V DC	41.61.9.060.0010	93.52.7.060
38.11.0.024.0060	24 V AC/DC	41.61.9.024.0010	93.52.0.024
38.11.0.060.0060	60 V AC/DC	41.61.9.060.0010	93.52.0.060
38.11.0.125.0060	125 V AC/DC	41.61.9.110.0010	93.52.0.125
38.11.0.240.0060	240 V AC/DC	41.61.9.110.0010	93.52.0.240
38.11.8.230.0060	230 V AC	41.61.9.110.0010	93.52.8.230

Approvals (according to type):



Certain relay/socket combinations

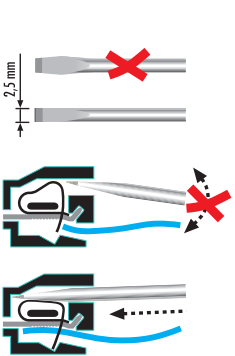

Screw terminal - 2 Pole relay 8 A

Interface Module Code	Coil voltage	Relay	Socket
38.52.0.024.0060	24 V AC/DC	41.52.9.024.0010	93.02.0.024
38.52.0.060.0060	60 V AC/DC	41.52.9.060.0010	93.02.0.060
38.52.0.125.0060	(110...125)V AC/DC	41.52.9.110.0010	93.02.0.125
38.52.0.240.0060	(220...240)V AC/DC	41.52.9.110.0010	93.02.0.240
38.52.7.012.0050	12 V DC	41.52.9.012.0010	93.02.7.024
38.52.7.024.0050	24 V DC	41.52.9.024.0010	93.02.7.024
38.52.7.060.0050	60 V DC	41.52.9.060.0010	93.02.7.060
38.52.8.230.0060	(230...240)V AC	41.52.9.110.0010	93.02.8.230

Screwless terminal - 2 Pole relay 8 A

Interface Module Code	Coil voltage	Relay	Socket
38.62.0.024.0060	24 V AC/DC	41.52.9.024.0010	93.52.0.024
38.62.0.060.0060	60 V AC/DC	41.52.9.060.0010	93.52.0.060
38.62.0.125.0060	(110...125)V AC/DC	41.52.9.110.0010	93.52.0.125
38.62.0.240.0060	(220...240)V AC/DC	41.52.9.110.0010	93.52.0.240
38.62.7.012.0050	12 V DC	41.52.9.012.0010	93.52.7.024
38.62.7.024.0050	24 V DC	41.52.9.024.0010	93.52.7.024
38.62.7.060.0050	60 V DC	41.52.9.060.0010	93.52.7.060
38.62.8.230.0060	(230...240)V AC	41.52.9.110.0010	93.52.8.230

Solid State Relay & Socket Combinations - 6.2 mm wide

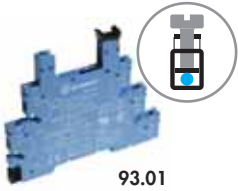

93.01



93.51

Approvals
(according to type):



Certain relay/socket combinations

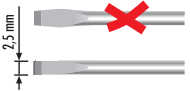

Screw terminal

Interface Module Code	Input voltage	Relay	Socket
38.81.7.006.xxxx	6 V DC	34.81.7.005.xxxx	93.01.7.024
38.81.7.024.xxxx	24 V DC	34.81.7.024.xxxx	93.01.7.024
38.81.7.060.xxxx	60 V DC	34.81.7.060.xxxx	93.01.7.060
38.81.0.125.xxxx	(110...125)V AC/DC	34.81.7.060.xxxx	93.01.0.125
38.81.0.240.xxxx	(220...240)V AC/DC	34.81.7.060.xxxx	93.01.0.240
38.81.3.125.xxxx	(110...125)V AC/DC	34.81.7.060.xxxx	93.01.3.125
38.81.3.240.xxxx	(230...240)V AC	34.81.7.060.xxxx	93.01.3.240

Screwless terminal

Interface Module Code	Input voltage	Relay	Socket
38.91.7.006.xxxx	6 V DC	34.81.7.005.xxxx	93.51.7.024
38.91.7.024.xxxx	24 V DC	34.81.7.024.xxxx	93.51.7.024
38.91.7.060.xxxx	60 V DC	34.81.7.060.xxxx	93.51.7.060
38.91.0.125.xxxx	(110...125)V AC/DC	34.81.7.060.xxxx	93.51.0.125
38.91.0.240.xxxx	(220...240)V AC/DC	34.81.7.060.xxxx	93.51.0.240
38.91.3.125.xxxx	(110...125)V AC/DC	34.81.7.060.xxxx	93.51.3.125
38.91.3.240.xxxx	(230...240)V AC	34.81.7.060.xxxx	93.51.3.240

Example: .xxxx

.9024

.7048

.8240

Solid State Relay & Socket Combinations - 14 mm wide



93.52

Approvals
(according to type):



Screw terminal

Interface Module Code	Input voltage	Relay	Socket
38.31.0.024.xxxx	24 V AC/DC	41.81.7.024.xxxx	93.02.0.024
38.31.7.012.xxxx	12 V DC	41.81.7.012.xxxx	93.02.7.024
38.31.7.024.xxxx	24 V DC	41.81.7.024.xxxx	93.02.7.024

Screwless terminal

Interface Module Code	Input voltage	Relay	Socket
38.41.0.024.xxxx	24 V AC/DC	41.81.7.024.xxxx	93.52.0.024
38.41.7.012.xxxx	12 V DC	41.81.7.012.xxxx	93.52.7.024
38.41.7.024.xxxx	24 V DC	41.81.7.024.xxxx	93.52.7.024

SSR / EMR & Timer Socket Combinations

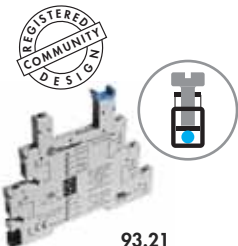

93.21

Approvals
(according to type):



Screw terminal

Interface Module Code	Input / Coil voltage	Relay	Socket
38.21.0.012.0060	12 V AC/DC	34.51.7.012.0010	93.21.0.024
38.21.0.024.0060	24 V AC/DC	34.51.7.024.0010	93.21.0.024
38.21.0.024.xxxx	24 V AC/DC	34.81.7.024.xxxx	93.21.0.024

Accessories

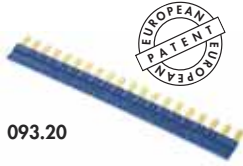

093.20

Approvals
(according to type):



20-way jumper link for 38.21/51/61/81/91	093.20 (blue)	093.20.0 (black)	093.20.1 (red)
Rated values	36 A - 250 V		

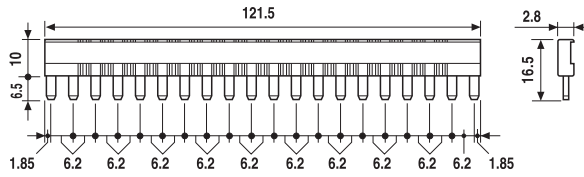

093.08

Approvals
(according to type):



8-way jumper link for 38.01/11/31/41/52/62	093.08 (blue)	093.08.0 (black)	093.08.1 (red)
Rated values	10 A - 250 V		

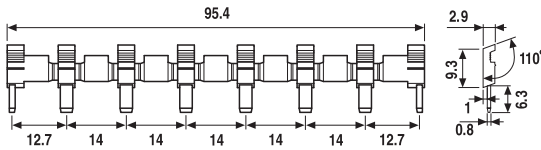

093.01

Plastic separator	093.01
--------------------------	--------

Thickness 2 mm, required at the start and the end of a group of interfaces.
Can be used for visual separation group, must be used for:
- protective separation of different voltages of neighbouring PLC interfaces according to VDE 0106-101
- protection of cut jumper links

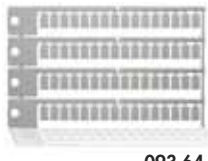

093.64

Sheet of marker tags for 38.21/51/61/81/91, plastic, 64 tags, 6x10 mm	093.64
--	--------

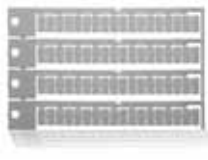

060.72

Sheet of marker tags for 38.01/11/31/41/52/62, plastic, 72 tags, 6x12 mm	060.72
---	--------

Below is a list of articles with direct links to our shop Electric Automation Network where you can see:

- Quote per purchase volume in real time.
- Online documentation and datasheets of all products.
- Estimated delivery time enquiry in real time.
- Logistics systems for the shipment of materials almost anywhere in the world.
- Purchasing management, order record and tracking of shipments.

To access the product, [click on the green button.](#)

Product	Code	Reference	Product link
PC programming kit for 12.71	01200	012.00	Buy on EAN
Plastic separator	09301	093.01	Buy on EAN
8-way jumper link	09308	093.08	Buy on EAN
8-way jumper link	093080	093.08.0	Buy on EAN
20-way jumper link	09320	093.20	Buy on EAN
20-way jumper link; black	093200	093.20.0	Buy on EAN
20-way jumper link; red	093201	093.20.1	Buy on EAN
Sheet of 64 plottable snap-in identification tags	09364	093.64	Buy on EAN
Electromechanical Relay; AgNi; 1CO 6A	345170050010	34.51.7.005.0010	Buy on EAN
Electromechanical Relay; AgNi; 1CO 6A	345170120010	34.51.7.012.0010	Buy on EAN
Electromechanical Relay; AgNi; 1CO 6A	345170240010	34.51.7.024.0010	Buy on EAN
Electromechanical Relay; AgNi; 1CO 6A	345170480010	34.51.7.048.0010	Buy on EAN
Electromechanical Relay; AgNi; 1CO 6A	345170600010	34.51.7.060.0010	Buy on EAN
Electromechanical Relay; Screw Terminals; AgNi; 1 pole 16A; 24V AC/DC	380100240060	38.01.0.024.0060	Buy on EAN
Electromechanical Relay; Screw Terminals; AgNi; 1 pole 16A; 60V AC/DC	380100600060	38.01.0.060.0060	Buy on EAN

Electromechanical Relay; Screw Terminals; AgNi; 1 pole 16A; 110...125V AC/DC	380101250060	38.01.0.125.0060	Buy on EAN
Electromechanical Relay; Screw Terminals; AgNi; 1 pole 16A; 230...240V AC/DC	380102400060	38.01.0.240.0060	Buy on EAN
Electromechanical Relay; Screw Terminals; AgNi; 1 pole 16A; 12V DC	380170120050	38.01.7.012.0050	Buy on EAN
Electromechanical Relay; Screw Terminals; AgNi; 1 pole 16A; 24V DC	380170240050	38.01.7.024.0050	Buy on EAN
Electromechanical Relay; Screw Terminals; AgNi; 1 pole 16A; 60V DC	380170600050	38.01.7.060.0050	Buy on EAN
Electromechanical Relay; Screwless Terminals; AgNi; 1 pole 16A; 24V AC/DC	381100240060	38.11.0.024.0060	Buy on EAN
Electromechanical Relay; Screwless Terminals; AgNi; 1 pole 16A; 60V AC/DC	381100600060	38.11.0.060.0060	Buy on EAN
Electromechanical Relay; Screwless Terminals; AgNi; 1 pole 16A; 110...125V AC/DC	381101250060	38.11.0.125.0060	Buy on EAN
Electromechanical Relay; Screwless Terminals; AgNi; 1 pole 16A; 230...240V AC/DC	381102400060	38.11.0.240.0060	Buy on EAN
Electromechanical Relay; Screwless Terminals; AgNi; 1 pole 16A; 12V DC	381170120050	38.11.7.012.0050	Buy on EAN
Electromechanical Relay; Screwless Terminals; AgNi; 1 pole 16A; 24V DC	381170240050	38.11.7.024.0050	Buy on EAN
Electromechanical Relay; Screwless Terminals; AgNi; 1 pole 16A; 60V DC	381170600050	38.11.7.060.0050	Buy on EAN
Timed interface module; Screw terminals; Multifunction: AI,DI,GI,SW; 1 pole 6A; Electromechanical relay; 12VAC/DC	382100120060	38.21.0.012.0060	Buy on EAN
Timed interface module; Screw terminals; Multifunction: AI,DI,GI,SW; 1 pole 6A; Electromechanical relay; 24VAC/DC	382100240060	38.21.0.024.0060	Buy on EAN
Electromechanical Relay; Screw Terminals; AgNi; 1 pole 6A; 12V AC/DC	385100120060	38.51.0.012.0060	Buy on EAN
Electromechanical Relay; Screw Terminals; AgNi; 1 pole 6A; 24V AC/DC	385100240060	38.51.0.024.0060	Buy on EAN
Electromechanical Relay; Screw Terminals; AgNi; 1 pole 6A; 48V AC/DC	385100480060	38.51.0.048.0060	Buy on EAN
Electromechanical Relay; Screw Terminals; AgNi; 1 pole 6A; 60V AC/DC	385100600060	38.51.0.060.0060	Buy on EAN
Electromechanical Relay; Screw Terminals; AgNi; 6A; 110-125V AC/DC	385101250060	38.51.0.125.0060	Buy on EAN
Electromechanical Relay; Screw Terminals; AgNi; 1 pole 6A; 230-240V AC/DC	385102400060	38.51.0.240.0060	Buy on EAN
Leakage current suppression; Electromechanical Relay; Screw Terminals; AgNi; 6A; 110-125V AC/DC	385131250060	38.51.3.125.0060	Buy on EAN

Leakage current suppression; Electromechanical Relay; Screw Terminals; AgNi; 6A; 230-240V AC	385132400060	38.51.3.240.0060	Buy on EAN
Electromechanical Relay; Screw Terminals; AgNi; 1 pole 6A; 6V DC	385170060050	38.51.7.006.0050	Buy on EAN
Electromechanical Relay; Screw Terminals; AgNi; 1 pole 6A; 12V DC	385170120050	38.51.7.012.0050	Buy on EAN
Electromechanical Relay; Screw Terminals; AgNi; 1 pole 6A; 24V DC	385170240050	38.51.7.024.0050	Buy on EAN
Electromechanical Relay; Screw Terminals; AgNi; 1 pole 6A; 48V DC	385170480050	38.51.7.048.0050	Buy on EAN
Electromechanical Relay; Screw Terminals; AgNi; 1 pole 6A; 60V DC	385170600050	38.51.7.060.0050	Buy on EAN
Electromechanical Relay; Screw Terminals; AgNi; 1 pole 6A; 230-240V AC	385182400060	38.51.8.240.0060	Buy on EAN
Electromechanical Relay; Screw Terminals; AgNi; 2 pole 8A; 24V AC/DC	385200240060	38.52.0.024.0060	Buy on EAN
Electromechanical Relay; Screw Terminals; AgNi; 2 pole 8A; 60V AC/DC	385200600060	38.52.0.060.0060	Buy on EAN
Electromechanical Relay; Screw Terminals; AgNi; 2 pole 8A; 125V AC/DC	385201250060	38.52.0.125.0060	Buy on EAN
Electromechanical Relay; Screw Terminals; AgNi; 2 pole 8A; 240V AC/DC	385202400060	38.52.0.240.0060	Buy on EAN
Electromechanical Relay; Screw Terminals; AgNi; 2 pole 8A; 12V DC	385270120050	38.52.7.012.0050	Buy on EAN
Electromechanical Relay; Screw Terminals; AgNi; 2 pole 8A; 24V DC	385270240050	38.52.7.024.0050	Buy on EAN
Electromechanical Relay; Screw Terminals; AgNi; 2 pole 8A; 60V DC	385270600050	38.52.7.060.0050	Buy on EAN
Electromechanical Relay; Screw Terminals; AgNi; 2 pole 8A; 230V AC	385282300060	38.52.8.230.0060	Buy on EAN
Electromechanical Relay; Screwless Terminals; AgNi; 1 pole 6A; 12V AC/DC	386100120060	38.61.0.012.0060	Buy on EAN
Electromechanical Relay; Screwless Terminals; AgNi; 1 pole 6A; 24V AC/DC	386100240060	38.61.0.024.0060	Buy on EAN
Electromechanical Relay; Screwless Terminals; AgNi; 1 pole 6A; 110-125V AC/DC	386101250060	38.61.0.125.0060	Buy on EAN
Electromechanical Relay; Screwless Terminals; AgNi; 1 pole 6A; 230-240V AC/DC	386102400060	38.61.0.240.0060	Buy on EAN
Leakage current suppression; Electromechanical Relay; Screwless Terminals; AgNi; 1 pole 6A; 110-125V AC/DC	386131250060	38.61.3.125.0060	Buy on EAN
Leakage current suppression; Electromechanical Relay; Screwless Terminals; AgNi; 1 pole 6A; 230-240V AC	386132400060	38.61.3.240.0060	Buy on EAN
Electromechanical Relay; Screwless Terminals; AgNi; 1 pole 6A; 12V DC	386170120050	38.61.7.012.0050	Buy on EAN

Electromechanical Relay; Screwless Terminals; AgNi; 1 pole 6A; 24V DC	386170240050	38.61.7.024.0050	Buy on EAN
Electromechanical Relay; Screwless Terminals; AgNi; 2 pole 8A; 24V AC/DC	386200240060	38.62.0.024.0060	Buy on EAN
Electromechanical Relay; Screwless Terminals; AgNi; 2 pole 8A; 60V AC/DC	386200600060	38.62.0.060.0060	Buy on EAN
Electromechanical Relay; Screwless Terminals; AgNi; 2 pole 8A; 125V AC/DC	386201250060	38.62.0.125.0060	Buy on EAN
Electromechanical Relay; Screwless Terminals; AgNi; 2 pole 8A; 240V AC/DC	386202400060	38.62.0.240.0060	Buy on EAN
Electromechanical Relay; Screwless Terminals; AgNi; 2 pole 8A; 12V DC	386270120050	38.62.7.012.0050	Buy on EAN
Electromechanical Relay; Screwless Terminals; AgNi; 2 pole 8A; 24V DC	386270240050	38.62.7.024.0050	Buy on EAN
Electromechanical Relay; Screwless Terminals; AgNi; 2 pole 8A; 60V DC	386270600050	38.62.7.060.0050	Buy on EAN
Electromechanical Relay; Screwless Terminals; AgNi; 2 pole 8A; 230V AC	386282300060	38.62.8.230.0060	Buy on EAN
5.0mm pinning; AgNi; Flux proof; 2CO 8A	415290120010	41.52.9.012.0010	Buy on EAN
5.0mm pinning; AgNi; Flux proof; 2CO 8A	415290240010	41.52.9.024.0010	Buy on EAN
5.0mm pinning; AgNi; Flux proof; 2CO 8A	415290600010	41.52.9.060.0010	Buy on EAN
5.0mm pinning; AgNi; Flux proof; 2CO 8A	415291100010	41.52.9.110.0010	Buy on EAN
5.0mm pinning; AgNi; Flux proof; 1CO 16A	416190120010	41.61.9.012.0010	Buy on EAN
5.0mm pinning; AgNi; Flux proof; 1CO 16A	416190240010	41.61.9.024.0010	Buy on EAN
5.0mm pinning; AgNi; Flux proof; 1CO 16A	416190600010	41.61.9.060.0010	Buy on EAN
5.0mm pinning; AgNi; Flux proof; 1CO 16A	416191100010	41.61.9.110.0010	Buy on EAN
Screw terminal socket	93010024	93.01.0.024	Buy on EAN
Screw terminal socket	93010060	93.01.0.060	Buy on EAN
Screw terminal socket	93010125	93.01.0.125	Buy on EAN
Screw terminal socket	93010240	93.01.0.240	Buy on EAN
Screw terminal socket; Leakage current suppression	93013125	93.01.3.125	Buy on EAN
Screw terminal socket; Leakage current suppression	93013240	93.01.3.240	Buy on EAN
Screw terminal socket	93017024	93.01.7.024	Buy on EAN

Screw terminal socket	93017060	93.01.7.060	Buy on EAN
Screw terminal socket	93018240	93.01.8.240	Buy on EAN
Screw terminal socket	93020024	93.02.0.024	Buy on EAN
Screw terminal socket	93020060	93.02.0.060	Buy on EAN
Screw terminal socket	93020125	93.02.0.125	Buy on EAN
Screw terminal socket	93020240	93.02.0.240	Buy on EAN
Screw terminal socket	93027024	93.02.7.024	Buy on EAN
Screw terminal socket	93027060	93.02.7.060	Buy on EAN
Screw terminal socket	93028230	93.02.8.230	Buy on EAN
Screw terminal TIMER SOCKET	93210024	93.21.0.024	Buy on EAN
Screwless terminal socket (spring cage clamps)	93510024	93.51.0.024	Buy on EAN
Screwless terminal socket (spring cage clamps)	93510125	93.51.0.125	Buy on EAN
Screwless terminal socket (spring cage clamps)	93510240	93.51.0.240	Buy on EAN
Screwless terminal socket (spring cage clamps); Leakage current suppression	93513125	93.51.3.125	Buy on EAN
Screwless terminal socket (spring cage clamps); Leakage current suppression	93513240	93.51.3.240	Buy on EAN
Screwless terminal socket (spring cage clamps)	93517024	93.51.7.024	Buy on EAN
Screwless terminal socket (spring cage clamps)	93517060	93.51.7.060	Buy on EAN
Screwless terminal socket (spring cage clamps)	93520024	93.52.0.024	Buy on EAN
Screwless terminal socket (spring cage clamps)	93520060	93.52.0.060	Buy on EAN
Screwless terminal socket (spring cage clamps)	93520125	93.52.0.125	Buy on EAN
Screwless terminal socket (spring cage clamps)	93520240	93.52.0.240	Buy on EAN
Screwless terminal socket (spring cage clamps)	93527024	93.52.7.024	Buy on EAN
Screwless terminal socket (spring cage clamps)	93527060	93.52.7.060	Buy on EAN
Screwless terminal socket (spring cage clamps)	93528230	93.52.8.230	Buy on EAN