



drives for position switches 3SE55 (old 3SE.200 and 3SE.210) Roller lever



Substance Prohibittance (Date)

07/01/2006

Certificates/ approvals

General Product Approval	Declaration of Conformity	other
Confirmation 	UK Declaration of Conformity  EG-Konf.	Confirmation

Further information

Information- and Downloadcenter (Catalogs, Brochures,...)

<https://www.siemens.com/ic10>

Industry Mall (Online ordering system)

<https://mall.industry.siemens.com/mall/en/en/Catalog/product?mlfb=3SX3171>

Cax online generator

<http://support.automation.siemens.com/WW/CAXorder/default.aspx?lang=en&mlfb=3SX3171>

Service&Support (Manuals, Certificates, Characteristics, FAQs,...)

<https://support.industry.siemens.com/cs/ww/en/ps/3SX3171>

Image database (product images, 2D dimension drawings, 3D models, device circuit diagrams, EPLAN macros, ...)

http://www.automation.siemens.com/bilddb/cax_de.aspx?mlfb=3SX3171&lang=en

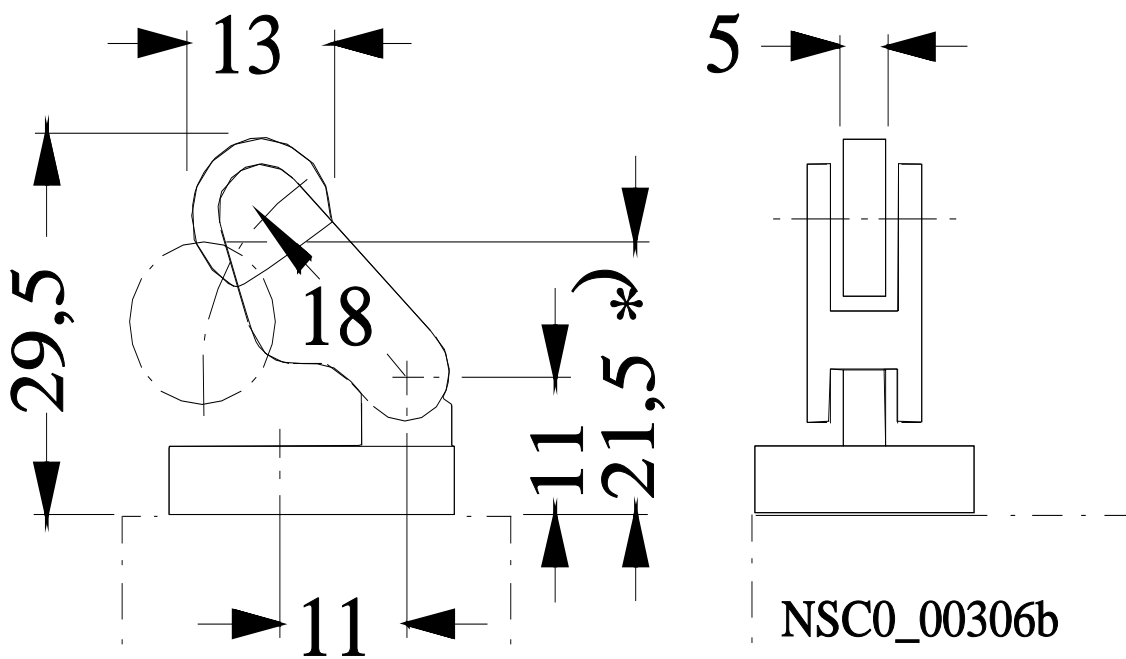

last modified:

12/21/2020 [↗](#)