

## Wall mounted socket

Part no. 136A



- screw terminals
- X-CONTACT®
- internal fixing
- enclosure base can be turned 180°
- with 6 fixing points to accommodate special terminals
- products with pilot contact on request

## Technical specifications

|                           |                 |
|---------------------------|-----------------|
| Ampere                    | 63 A            |
| Poles                     | 5 p             |
| Voltage                   | 400 V           |
| Clock position            | 6 h             |
| Hertz                     | 50-60 Hz        |
| Connection technology     | Screw terminals |
| Contact                   | X-CONTACT®      |
| Protection type           | IP 67           |
| Weight                    | 1006 g          |
| Declaration of Conformity | VDE, EAC, CQC   |

## Drawing

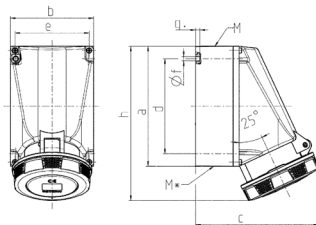

| Drawing<br>1 MB 112 | Amp.<br>Poles                                   | 63                         |       |       |
|---------------------|---|----------------------------|-------|-------|
|                     |   | 3                          | 4     | 5     |
| Dim. in mm          | a   | 170                        | 170   | 170   |
|                     | b   | 118                        | 118   | 118   |
|                     | c   | 175                        | 175   | 175   |
|                     | d   | 134.5                      | 134.5 | 134.5 |
|                     | e   | 103                        | 103   | 103   |
|                     | f   | 6.1                        | 6.1   | 6.1   |
|                     | g   | 6                          | 6     | 6     |
|                     | h   | 219                        | 219   | 219   |
|                     | M   | 40                         | 40    | 40    |
|                     | M*  | 2x40 (blind) to be cut out |       |       |
|                     | Max. cable diam. (mm)                           | 27                         | 27    | 27    |
|                     | Terminal for cond. cross section (mm²) min-max. | 6                          | 6     | 6     |
|                     |   | -25                        | -25   | -25   |