

Covered with Pvc tube

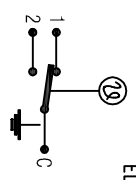

ELECTRIC DIAGRAM

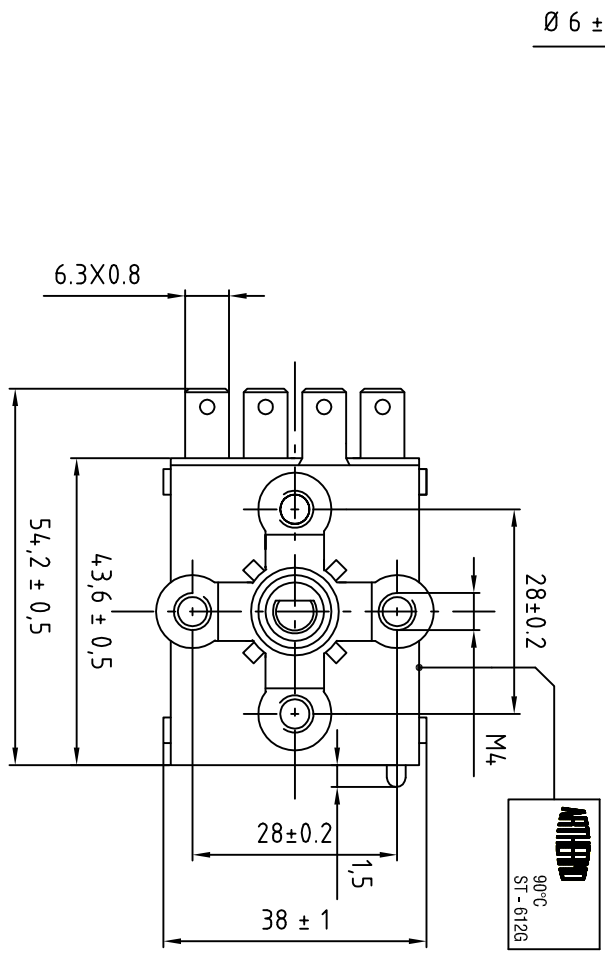

Technical Data

H/OFF :	90°C ± 3°C
L/OFF :	0°C
BREAKING CAPACITY	C-1 15(2,5)A 400 VAC C-2 2,5(0,4)A 400VAC
MAX °C AROUND THE BODY:	T110°C
MAX °C AROUND THE BULB:	UPPER SWITCHING VALUE +15%
LIFE OF PRODUCTS:	100.000 CYCLES
DIFFERENTIAL:	4 ± 2,5°C
MINIMUM CURRENT:	200 mA
INSULATION RESISTANCE:	> 100 M OHM
RIF.	90C-556-12G



DESCRIZIONE :
Termostato reg. 0/90°C SP-DT cap. mm 1500 frame Faston 6,3 X 0,8

SCALA :	1:2	DISEGNATO:	SALA A.	MODIFICA :	DATA:
DATA :	28-10-2003	CONTROLLATO:			
TOLL. GEN. :	+/-0,1				
Descrizione revisione :				Data	
Descrizione revisione :				Data	
Descrizione revisione :				Data	

TERMOSTATO COMPLETO DI ACCESSORI (MANOPOLA - GHIERA E VITI)
COD. C70502112N