





ALPHA DIN wspornik izolacyjny 31,5 mm do izolowanego montażu szyn montażowych duże opakowanie: 50 szt.



Wersja	
Nazwa markowa produktu	ALPHA
materiał	tworzywo sztuczne
Konstrukcja mechaniczna	
wysokość	31,5 mm
Waga netto na jedn.	12,5 g
Zezwolenia Certyfikaty	
Environment	General Product Approval
Environmental Conformations	Environmental Conformations
	
	Confirmation
	
General Product Approval	
Test Certificates	other
	Special Test Certificate
	Confirmation
	Miscellaneous
	

Więcej informacji

Informacje dotyczące opakowania

[Informacje dotyczące opakowania](#)

Information for data generation and storage

<https://support.industry.siemens.com/cs/ww/en/view/109995012>

Information- and Downloadcenter (Catalogs, Brochures,...)

<https://www.siemens.com/lowvoltage/catalogs>

Industry Mall (Online ordering system)

<https://mall.industry.siemens.com/mall/en/en/Catalog/product?mlfb=8GK9911-0KK05>

Service&Support (Manuals, Certificates, Characteristics, FAQs,...)

<https://support.industry.siemens.com/cs/ww/pl/ps/8GK9911-0KK05>

Image database (product images, 2D dimension drawings, 3D models, device circuit diagrams, ...)

https://www.automation.siemens.com/bilddb/cax_en.aspx?mlfb=8GK9911-0KK05

CAX-Online-Generator

<https://www.siemens.com/cax>

Tender specifications

<https://www.siemens.com/specifications>

Krzywe charakterystyczne

[https://curves.simaris.siemens.com/curves/<mmp_prod_noCOMP="HAUPT"></mmp_prod_no>](https://curves.simaris.siemens.com/curves/<mmp_prod_noCOMP=)

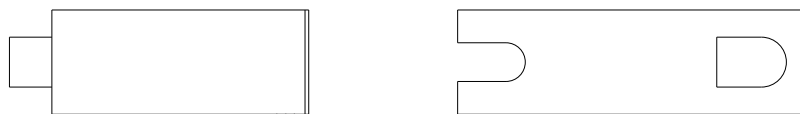

Ostatnia zmiana:

9.05.2026 

